

EN Original Instructions

These instructions apply to the Klaxon GP range of motor-driven sirens intended for use as part of an audible warning system (note that these sirens are not intended as a substitute for an EN 54 approved fire alarm system).

Installation

WARNING: Failure to comply with these instructions may result in a breach of the Protection Concept.

Fix siren to a firm level base using all four mounting holes and securely fasten with M10 bolts. Mount at a minimum height of 3m above the ground and free of side or top obstructions.

For best all round sound propagation, mount the unit at a height of 4.5 to 6m with 50m clear radius all round.

Fig 1 below shows a polar plot of the sound output from the sirens at 1 metre in ideal free-field conditions.

Sound levels - dB(A)

Distance	GP6	GP10	GP12
1m	135	140	145
30m	105	110	115
500m	81	86	91
1km	75	80	85
3km	65	70	75
5km	61	66	71

Note: Levels are indicated over unobstructed flat ground through still air in the prime direction.

Fig 1. Polar Plot of Sound Output (dBA@1m)

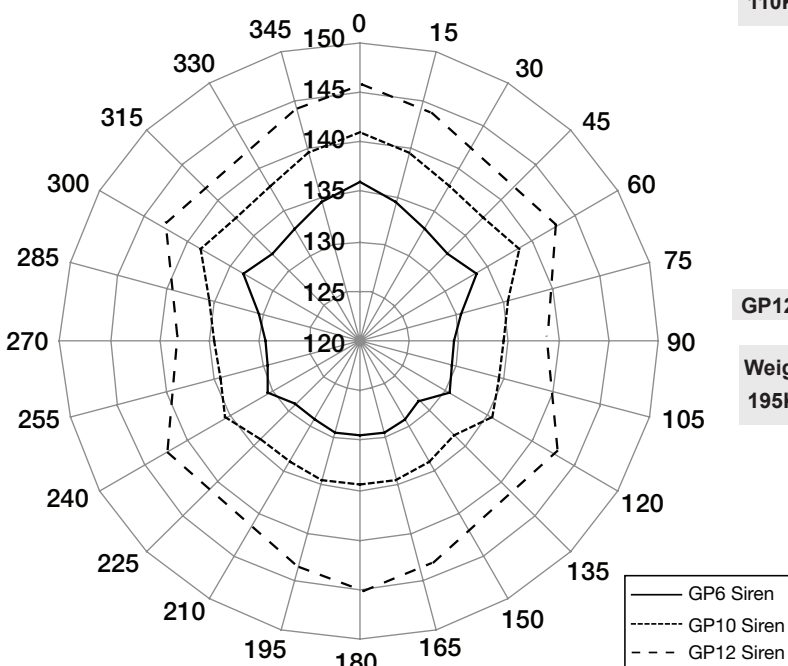

This equipment should only be connected to the supply voltage marked on the rating plate and protected by appropriate MCB/Overload devices. The motors are equipped with PTC thermal protection. The PTC should be connected to an appropriate tripping device.

The plastic restraining straps on the rotor should be cut away before testing siren for the first time.

Only lift using suitable lifting equipment (no manual lift) using all of the eye bolts. Ensure the eye bolts are removed following installation.

WARNING: The equipment should be protected from access by persons, animals or foreign bodies to avoid injury to persons or damage to equipment affecting safe use.

WARNING: This equipment contains rotating parts. Please ensure that the retaining straps on the rotor are left in place until the installation is complete and the equipment is ready to be tested for the first time.

WARNING: Keep well clear of the siren when in operation. Extremely high noise levels are produced. Unprotected exposure could lead to permanent hearing damage. Ensure appropriate hearing protection is used when working in close proximity to the siren.

In the event of a fault or breakdown contact Klaxon technical support.

Maintenance

The maintenance regime for the siren must be strictly followed in accordance with the approved site plan, or, where no plan exists, at least annually. The siren must be tested following any maintenance. The siren must be inspected at least quarterly to prevent build-up of dust or debris.

To allow for safe maintenance either the lockable isolator must be used on the control panel or a separate isolator switch should be installed near the siren.

GP6 Dimensions 492(l) x 398(w) x 438(h) mm

Weight
50Kg

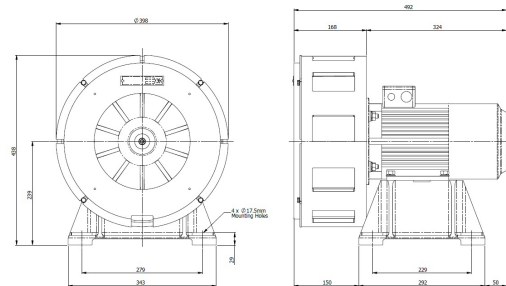

GP10 Dimensions 536(l) x 495(w) x 557(h) mm

Weight
110Kg

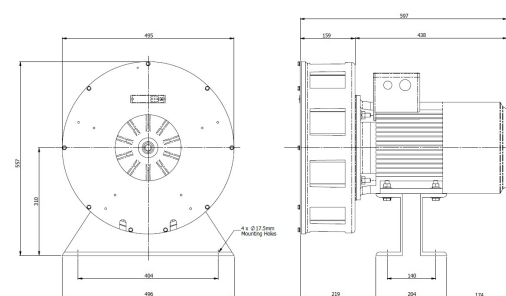

GP12 Dimensions 762(l) x 496(w) x 585(h) mm

Weight
195Kg

